

Inside the E-building:

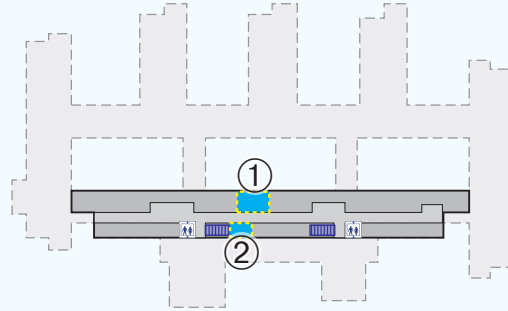

Fifth floor (Student Service, LTH):

- ① Seminar room "Everest", 5129
- ② Seminar room "K2", 5169

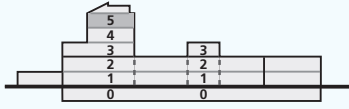
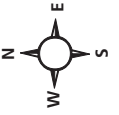
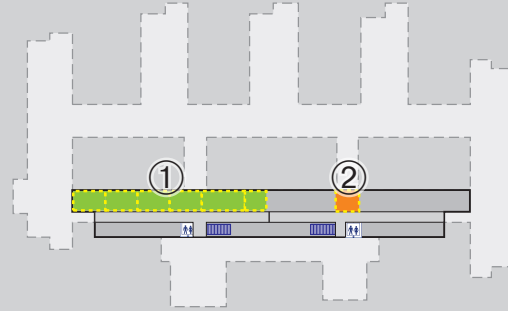
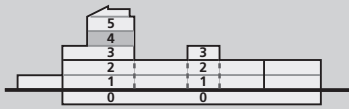

Fourth floor:

- ① EIT labs, 4115-24
- ② LUCAS room, 4130

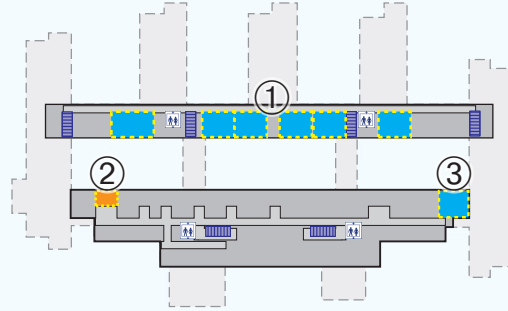
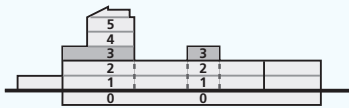

Third floor:

- ① Seminar rooms "33-salarna" in the east part of the building
- ② Conference room 3114C
- ③ Seminar room 3139

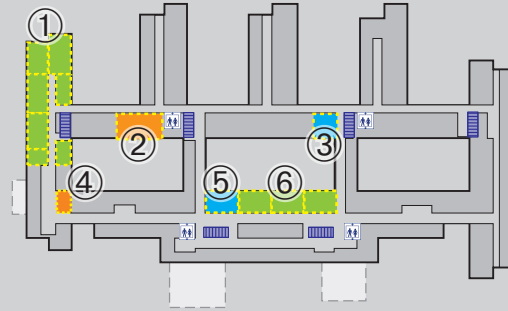
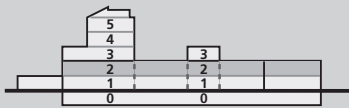

Second floor:

- ① Lab "Siberia" (24xx-labs)
- ② "the Orangerie", 2311
- ③ Seminar room 2349 ("the kitchen")
- ④ The "Glass cage" 2405
- ⑤ Seminar room 2116
- ⑥ Computer labs alfa, beta, gamma

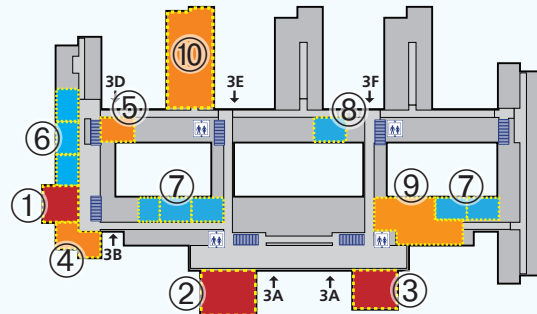
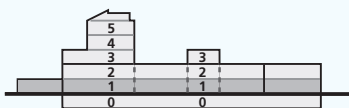

First floor:

- Auditorium: ① 1406, ② E:A, ③ E:B
- ④ Library
- ⑤ Meeting room 1426
- Seminar room: ⑥ 14xx, ⑦ 11xx, ⑧ 1328
- ⑨ Café
- ⑩ L-Tek

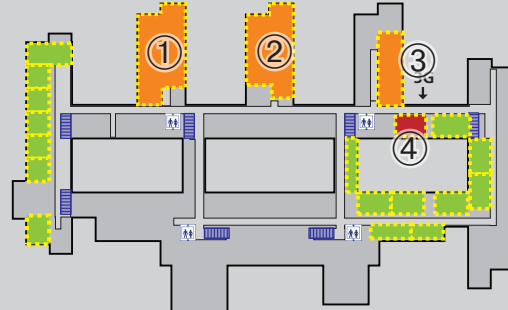
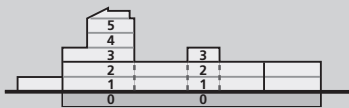

Basement:

- ① Edekvata, ② Idéet
- ③ Beadle office, goods receipt, print shop
- ④ Auditorium E:C